

PORTAVIB-38H-01 PORTABLE VIBRATOR (ECCENTRIC TYPE)

NO.	PART NO.	PART DESCRIPTION	QTY	UNIT PRICE (EUR) 2021
1	PORTAVIB-38H-PVE38-0101	VIBRATOR HEAD	1	33,18 €
2	PORTAVIB-38H-W04-28x3	O RING	3	0,90 €
3	PORTAVIB-38H-PVE38-0102	VIBRATOR BODY	1	40,08 €
4	PORTAVIB-38H-W03-26x15x7	OIL SEAL	2	4,32 €
5	PORTAVIB-38H-PVE38-0103	CONNECTOR	1	31,32 €
6	PORTAVIB-38H-W01-6902ZZ-J	BEARING	2	76,92 €
7	PORTAVIB-38H-PVE45-0106	HOSE JOINT B	1	147,24 €
8	PORTAVIB-38H-W24-30x450-5	FLEXIBLE HOSE	1	122,46 €
9	PORTAVIB-38H-VIBGA-0832	END CLIP	1	200,40 €
10	PORTAVIB-38H-VIBG-0815	PROTECTOR SPRING	1	17,28 €
11	PORTAVIB-38H-VIB38-0106	HOSE JOINT A	1	50,58 €
12	PORTAVIB-38H-CH.RG28	INTERNAL CIRCLIP	1	0,54 €
13	PORTAVIB-38H-PVE45-0201	HOSE JOINT D	1	169,32 €
14	PORTAVIB-38H-W01-608ZZ-J	BEARING	2	70,68 €
15	PORTAVIB-38H-PVE45-0203	WASHER	1	36,06 €
16	PORTAVIB-38H-PVE45-0202	CONNECTED SETS	1	93,72 €
17	PORTAVIB-38H-HS.B-M6x16-8.8-GB-1	SCREW	1	0,48 €
18	PORTAVIB-38H-HS.B-M6x20-8.8-GB-1	SCREW	2	0,54 €
19	PORTAVIB-38H-PVE45-0204	CONNECTING SHAFT	1	46,56 €
20	PORTAVIB-38H-PVE45-0107	DRIVING SHAFT	1	75,30 €
21	PORTAVIB-38H-W25-10x470	FLEXIBLE SHAFT	1	83,82 €
22	PORTAVIB-38H-PVE38-0105	SHAFT JOINT	1	35,34 €
23	PORTAVIB-38H-W01-6001-J	BEARING	4	14,64 €
24	PORTAVIB-38H-PVE38-0104	VIBRATOR SHAFT	1	58,86 €
25	PORTAVIB-38H-CS.RG12	EXTERNAL CIRCLIP	1	0,54 €
26	PORTAVIB-38H-HS.B-M6x30-8.8-GB-1	SCREW	4	0,72 €
27	PORTAVIB-38H-HSPG.W6-DIN-1	SPRING WASHER,TANG ENDS	4	0,42 €
28	PORTAVIB-38H-PVE45-0900	CUT ROD ASSY	1	248,04 €
29	PORTAVIB-38H-W05-GX35T SDL	ENGINE	1	
30	PORTAVIB-38H-HCS50-1800	TANK PROTECTION PLATE	1	17,10 €
31	PORTAVIB-38H-HCS50-2400	INSERT	2	19,50 €
32	PORTAVIB-38H-HCS50-2500	INSERT	2	1,20 €
33	PORTAVIB-38H-FSH.S-M5x16-12.9-DIN-3	SCREW	2	0,72 €
34	PORTAVIB-38H-FSH.S-M5x30-12.9-DIN-3	SCREW	2	0,90 €
35	PORTAVIB-38H-PVE45-0800	WIRE	1	40,50 €
36	PORTAVIB-38H-SS.RG16	EXTERNAL CIRCLIP	1	1,74 €
37	PORTAVIB-38H-PVE38-1000	VIBRATOR HEAD & FLAXSHAFT ASSY		774,00 €

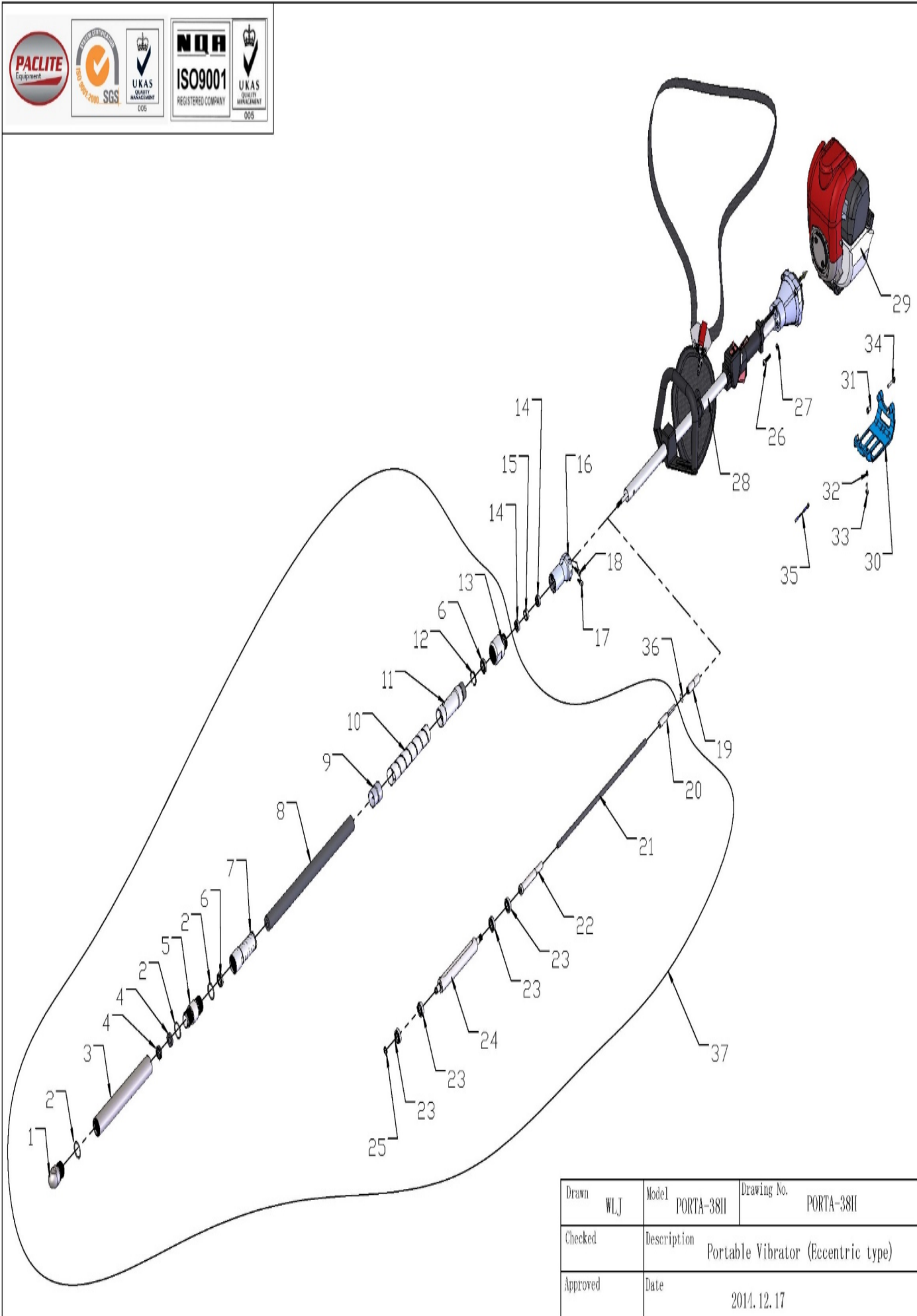

Drawn	WLJ	Model	PORTA-38II	Drawing No.	PORTA-38II
Checked		Description	Portable Vibrator (Eccentric type)		
Approved		Date	2014.12.17		