

Belt tension assembly for RBC

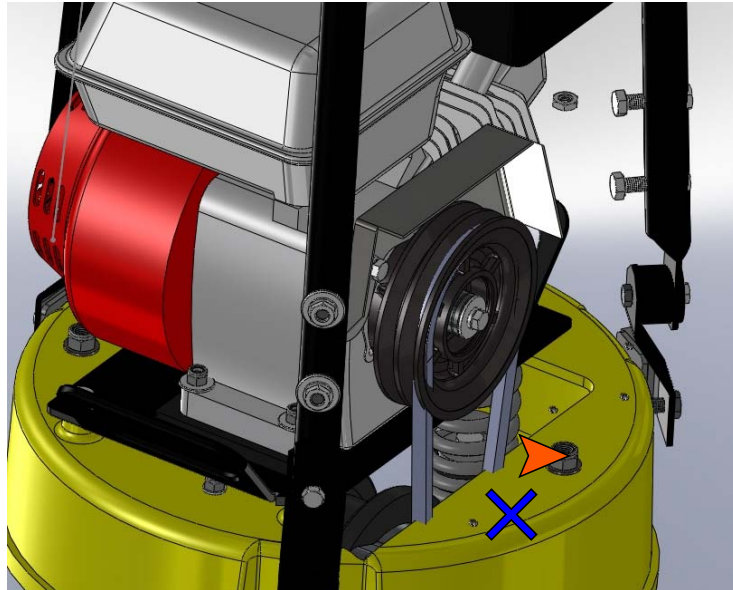

STEP:1-Remove the safety cover

STEP2:- Unscrew the lock nut



STEP-3 Tap a M8 (hole)

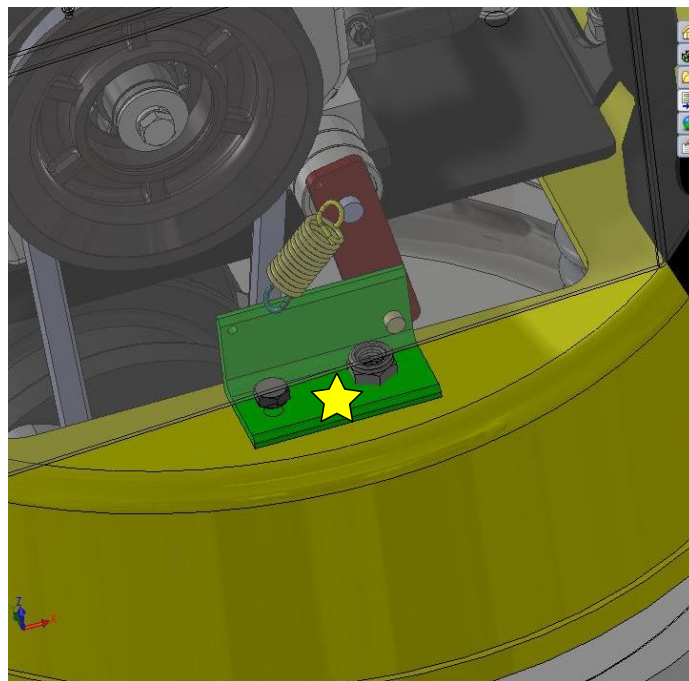

Check the Orientation of the part.. Rear face should be parallel to the cut in the base.

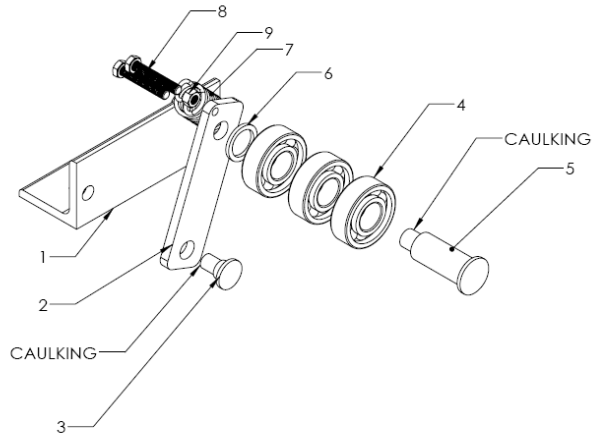

ITEM NO.	PART NUMBER	PART NAME	QTY.
1	RBC90-84-C	ATTACHMENT BASE	1
2	RBC90-85-B	CONNECTOR	1
3	RBC90-94-A	RIVET-LOWER	1
4	RBC90-96-A	BEARING	3
5	RBC90-95-A	RIVET-UPPER	1
6	RBC90-93-A	RETAINER	1
7	RBC90-90-A	SPRING	1
8	FN.B-M5x30-8.8-DIN-1		2
9	FN.N-M5-DIN-1		2

Note:

Step-4 : Tighten two M5 bolt One in Part number-2 and other in part number-1

Step-5: Use the spring to attach two bolts.

REVISED

1:38 pm, Dec 16, 2011