

HTL350-01 MAIN CHASSIS UNIT

NO.	PART NO.	PART DESCRIPTION	QTY
01-1	HTL350-FN.B-M10x25-8.8-DIN-2	BOLT	2
01-2	HTL350-HSPG.W10-DIN-2	SPRING WASHER, TANG ENDS	2
01-3	HTL350-022200	WASHER	2
01-4	HTL350-021600	NUT	8
01-5	HTL350-000001	WHEEL	2
01-6	HTL350-W01-6204ZZ-J	BEARING	4
01-7	HTL350-021400	WHEEL HUB	2
01-8	HTL350-010000	MIAN CHASSIS	1
01-9	HTL350-010300	RUBBER GROMMET	3
01-10	HTL350-W05-GXV160UH2-N1F	ENGINE	1
01-11	HTL350-FN.W8-DIN-2	WASHER	24
01-12	HTL350-HSPG.W8-DIN-2	SPRING WASHER, TANG ENDS	13
01-13	HTL350-FN.B-5/16-24x1¼-DIN-2	BOLT	4
01-14	HTL350-020302	BUSH	1
01-15	HTL350-020301	PULLEY	1
01-16	HTL350-FN.B-M8x45-8.8HALF-DIN-2	BOLT	4
01-17	HTL350-IN.N-M8-DIN-2	LOCK NUT	19
01-18	HTL350-FN.N-M8-DIN-2	NUT	5
01-19	HTL350-FN.B-M8x55-8.8HALF-DIN-2	BOLT	3
01-20	HTL350-022000	PIN	1
01-21	HTL350-FN.B-M8x35-8.8HALF-DIN-2	BOLT	1
01-22	HTL350-FN.B-M8x20-8.8-DIN-2	BOLT	8
01-23	HTL350-020500	TRANSAXLE BRACKET B	1
01-24	HTL350-020400	TRANSAXLE BRACKET A	1
01-25	HTL350-HF.B-5/16-18x5/8-8.8-DIN-2	HEXAGON FLANGE BOLT	2
01-26	HTL350-010100	SOLEPLATE	1
01-27	HTL350-WOD.W8-GB-2	WASHER	8
01-28	HTL350-032300	LOCK BOLT	2
01-29	HTL350-022100	BUSH	2
01-30	HTL350-021300	SLIDE PLATE	1
01-31	HTL350-021200	SPRING	2
01-32	HTL350-FN.B-M12x45-8.8HALF-DIN-2	BOLT	1
01-33	HTL350-CH.RG32	INTERNAL CIRCLIP	1
01-34	HTL350-W01-6201ZZ-J	BEARING	1
01-35	HTL350-021000	TENSION PULLEY	1
01-36	HTL350-021100	BUSH,TENSION PULLEY	1
01-37	HTL350-020900	TENSION PULLEY ARM	1
01-38	HTL350-FN.W12-DIN-2	WASHER	2
01-39	HTL350-IN.N-M12-DIN-2	LOCK NUT	3
01-40	HTL350-FN.B-M8x25-8.8-DIN-2	BOLT	2
01-41	HTL350-FN.B-M12x60-8.8-DIN-2	BOLT	1
01-42	HTL350-020800	BUSH	1
01-43	HTL350-020700	GUIDE TUBE	1
01-44	HTL350-CHSN.B-M12x50-GB-2	SQUARE NECKBOLT	1
01-45	HTL350-FN.B-M8x30-8.8-DIN-2	BOLT	2
01-46	HTL350-020600	TENSION PULLEY BRACKET	1
01-47	HTL350-CHSN.B-M10x20-GB-2	SQUARE NECKBOLT	2

HTL350-01 MAIN CHASSIS UNIT

NO.	PART NO.	PART DESCRIPTION	QTY
01-48	HTL350-021800	CATCH	1
01-49	HTL350-FN.W10-DIN-2	WASHER	2
01-50	HTL350-IN.N-M10-DIN-2	LOCK NUT	2
01-51	HTL350-021700	BUCKET	1
01-52	HTL350-650-023100	GRIP	1

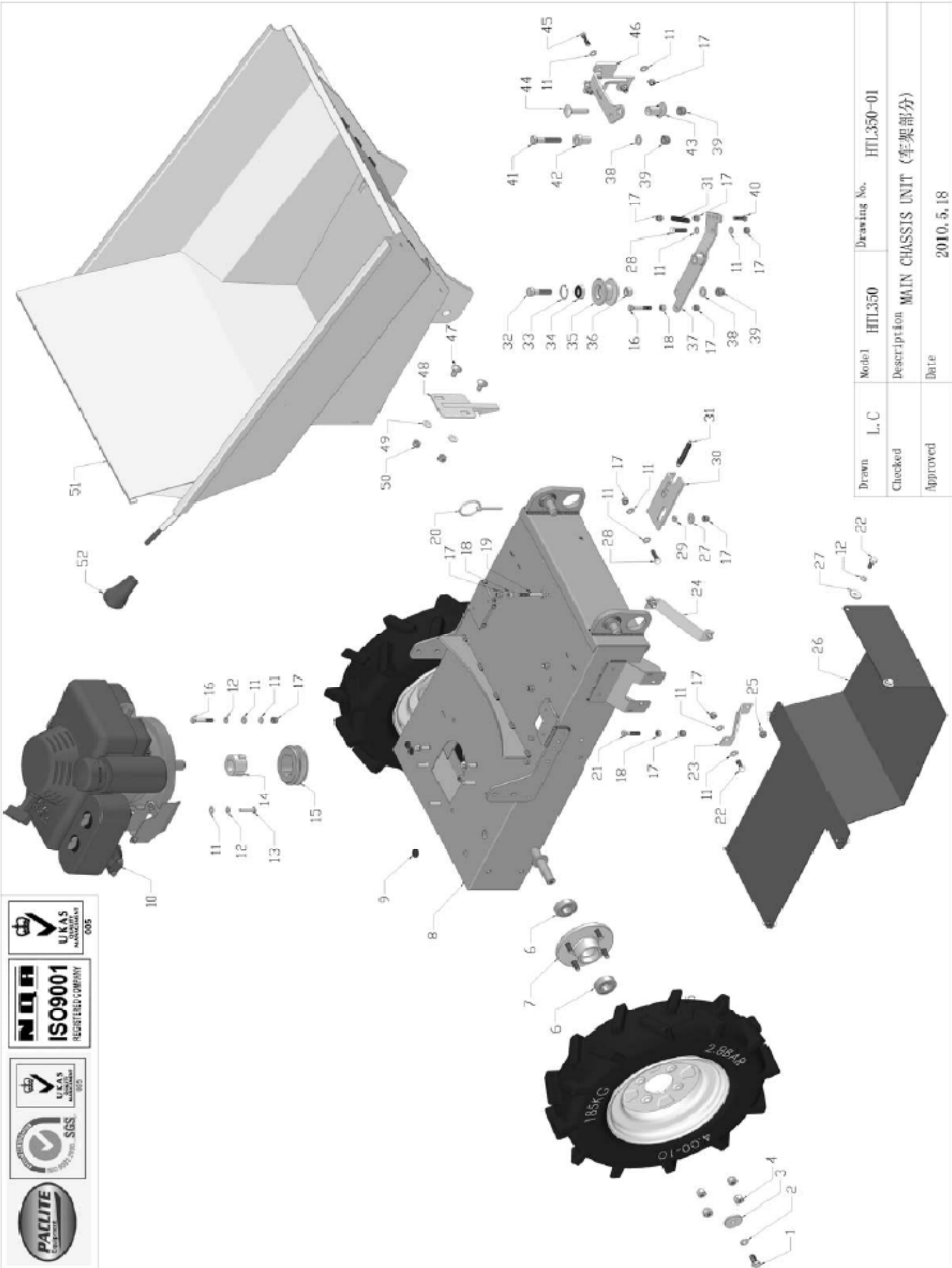
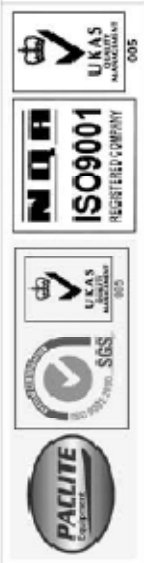

Drawn	L. C	Model	HTL350	Drawing No.	HTL350-01
Checked		Description	MAIN CHASSIS UNIT (车架部分)		
Approved		Date	2010. 5. 18		

HTL350-02 TRANSMISSION UNIT

NO.	PART NO.	PART DESCRIPTION	QTY
02-1	HTL350-021900	CAP	2
02-2	HTL350-ET.RG15	LOCK WASHER FOR SHAFTS	2
02-3	HTL350-021600	NUT	8
01-5	HTL350-000001	WHEEL	2
02-5	HTL350-021500	FLANGE, FRONT WHEEL	2
02-6	HTL350-CHSN.B-M8x20-GB-2	BOLT	4
02-7	HTL350-FN.W8-DIN-2	WASHER	17
02-8	HTL350-W01-PFT3/4TF-J	BEARING	2
02-9	HTL350-IN.N-M8-DIN-2	LOCK NUT	6
02-10	HTL350-Key.A-4.76x4.76x50.8	KEY	2
02-11	HTL350-020000	TRANSAXLE	1
02-12	HTL350-020100	TRIGGER	1
02-13	HTL350-WOD.W6-GB-2	WASHER	1
02-14	HTL350-HSPG.W6-DIN-2	SPRING WASHER, TANG ENDS	1
02-15	HTL350-FN.B-1/4-28x3/4-DIN-2	BOLT	1
02-16	HTL350-032300	LOCK BOLT	1
02-17	HTL350-021200	SPRING	1
02-18	HTL350-HSPG.W8-DIN-2	SPRING WASHER, TANG ENDS	8
02-19	HTL350-FN.B-M8x70-8.8HALF-DIN-2	BOLT	8
02-20	HTL350-010200	TRANSAXLE BRACKET	1
02-21	HTL350-020200	TRANSAXLE PULLEY	1
02-22	HTL350-FHSS.S-M8x20-GB-3	SOCKET SCREW WITH FLAT HEAD	2
02-23	HTL350-W02-SPA1400	V-BELT	1

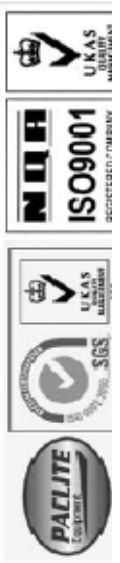

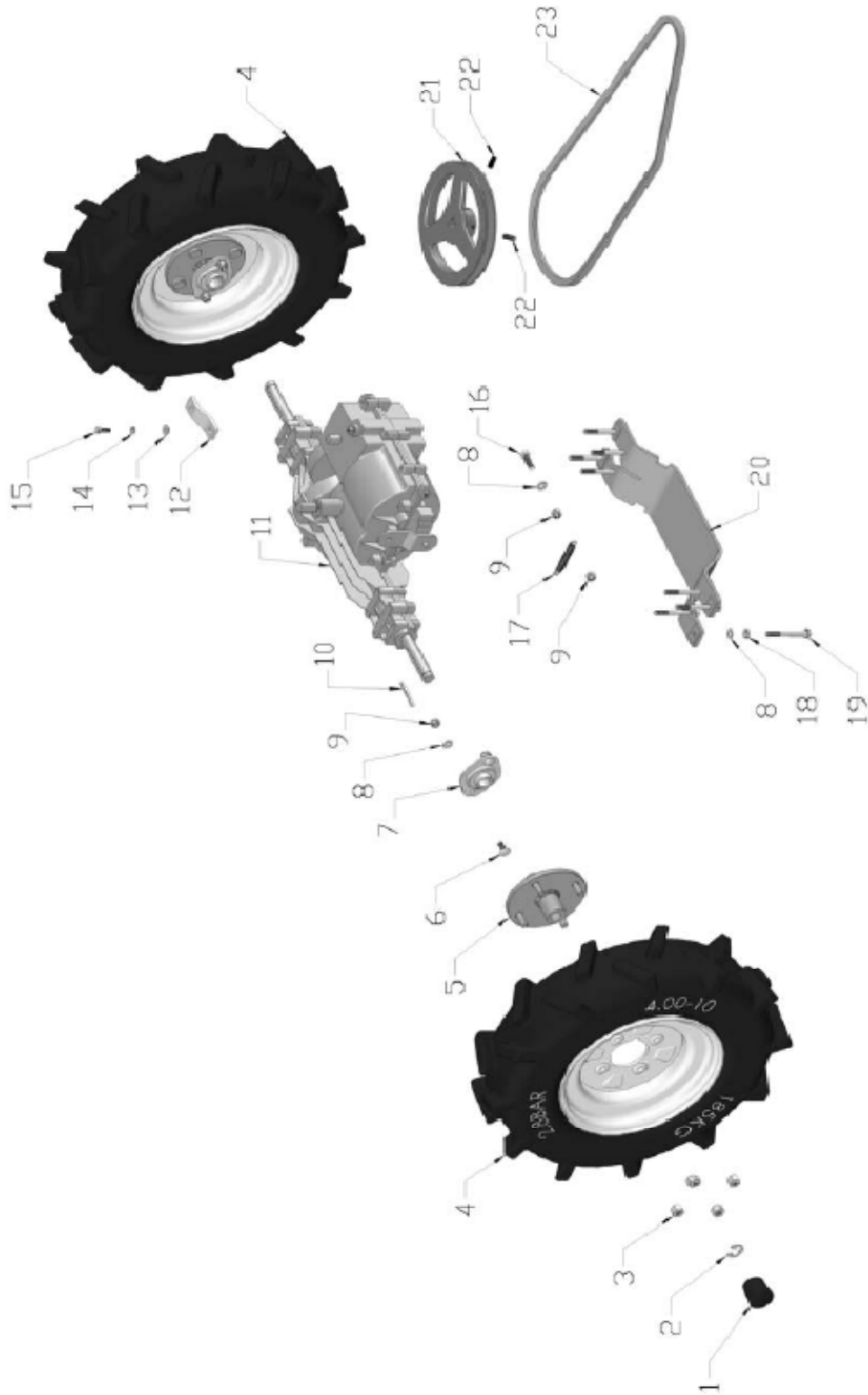

Drawn	L. C	Model	HTL350	Drawing No.	HTL350-02
Checked		Description	TRANSMISSION UNIT (传动部分)		
Approved		Date	2010. 1. 15		

HTL350-03 OPERATION UNIT

NO.	PART NO.	PART DESCRIPTION	QTY
03-1	HTL350-70B-010112P	FUEL TANK CAP	1
03-3	HTL350-70ND-010114	STRAINER	1
03-4	HTL350-HC.N-M6-DIN-2	CAP NUT	4
03-5	HTL350-HSPG.W6-DIN-2	SPRING WASHER, TANG ENDS	10
03-6	HTL350-WOD.W6-GB-2	WASHER	8
03-7	HTL350-032000	BUSH	3
03-8	HTL350-FN.B-M6x20-8.8-DIN-2	BOLT	4
03-9	HTL350-FN.B-M6x16-8.8-DIN-2	BOLT	6
03-10	HTL350-030100	COVER	1
03-11	HTL350-70B-010109	FUEL TANK	1
03-12	HTL350-70B-010110	STRAINER	1
03-13	HTL350-70ND-010115	PACKING	1
03-14	HTL350-85d-010113	FUEL TANK CAP ,BOTTOM	1
03-15	HTL350-70B-000020	FUEL VALVE	1
03-16	HTL350-032900	HOSE BAND	2
03-17	HTL350-032200	FUEL HOSE	1
03-18	HTL350-WOD.W8-GB-2	WASHER	2
03-19	HTL350-HSPG.W8-DIN-2	SPRING WASHER, TANG ENDS	14
03-20	HTL350-FN.B-M8x25-8.8-DIN-2	BOLT	2
03-21	HTL350-947-99921	HANDLE COVER	2
03-22	HTL350-031500	RIGHT LOADING WHEEL LEVER	1
03-23	HTL350-031400	LEFT LOADING WHEEL LEVER	1
03-24	HTL350-FN.B-M8x20-8.8-DIN-2	BOLT	10
03-25	HTL350-CPT80-0319	WASHER	2
03-26	HTL350-000002	LOADING WHEEL	2
03-27	HTL350-031300	RIGHT LOADING WHEEL COVER	1
03-28	HTL350-CHSN.B-M12x40-GB-2	SQUARE NECKBOLT	2
03-29	HTL350-031600	WASHER	2
03-30	HTL350-FN.W12-DIN-2	WASHER	6
03-31	HTL350-IN.N-M12-DIN-2	LOCK NUT	4
03-32	HTL350-FN.B-M12x35-8.8-DIN-2	BOLT	2
03-33	HTL350-031700	BUSH	2
03-34	HTL350-031800	WASHER	2
03-35	HTL350-CHSN.B-M8x25-GB-2	BOLT	2
03-36	HTL350-FN.W8-DIN-2	WASHER	12
03-37	HTL350-IN.N-M8-DIN-2	LOCK NUT	2
03-38	HTL350-031100	FRICTION WHEEL SHAFT	1
03-39	HTL350-031200	LEFT FRICTION WHEEL COVER	1
03-40	HTL350-032700	GRIP,GEAR SELECTOR ROD	1
03-41	HTL350-030400	GEAR SELECTOR ROD	1
03-42	HTL350-030600	NYLON BUSH	2
03-43	HTL350-030500	BUSH	1
03-44	HTL350-FHSS.S-M8x6-GB-2	GRUB SCREW	1
03-45	HTL350-030900	UNIVERSAL JOINT	1
03-46	HTL350-032100	NUT L.H	2
03-47	HTL350-030800	THREADED BAR	1

HTL350-03 OPERATION UNIT

NO.	PART NO.	PART DESCRIPTION	QTY
03-48	HTL350-FN.N-M10-DIN-2	NUT	1
03-49	HTL350-031000	UNIVERSAL JOINT	1
03-50	HTL350-IN.N-M10-DIN-2	LOCK NUT	6
03-51	HTL350-FN.N-M8-DIN-2	NUT	2
03-52	HTL350-030700	CONNECTOR	1
03-53	HTL350-FN.B-M8x35-8.8-DIN-2	BOLT	2
03-54	HTL350-000003	HAND GRIP	2
03-55	HTL350-032500	CONTROL LEVER	1
03-56	HTL350-032402	CONTROL LEVER	1
03-57	HTL350-032401	CONTROL LEVER	1
03-58	HTL350-032800	ADJUSTING SCREW	3
03-59	HTL350-031900	CONTROL CABLE	3
03-60	HTL350-030000	HANDLE	1
03-61	HTL350-030200	LEFT BRACKET	1
03-62	HTL350-FN.B-M10x30-8.8-DIN-2	BOLT	4
03-63	HTL350-FN.W10-DIN-2	WASHER	14
03-64	HTL350-HSPG.W10-DIN-2	SPRING WASHER, TANG ENDS	4
03-65	HTL350-FN.B-M10x25-8.8-DIN-2	BOLT	4
03-66	HTL350-030300	RIGHT BRACKET	1
03-67	HTL350-HC.N-M10-DIN-2	CAP NUT	1
03-68	HTL350-FNL.N-M10-DIN-2	HEXAGON THIN NUT	1
03-69	HTL350-70ND-060000	THROTTLE LEVER	1
03-70	HTL350-FHSS.S-M6x8-GB-3	SOCKET SCREW WITH FLAT HEAD	1
03-71	HTL350-70ND-060001	THROTTLE BODY	1
03-72	HTL350-W04-45x3	O-RING	1
03-73	HTL350-70ND-060003	BOLT	1
03-74	HTL350-70ND-060002	THROTTLE GEAR	1
03-75	HTL350-FHSS.S-M8x20-GB-3	SOCKET SCREW WITH FLAT HEAD	1
03-76	HTL350-70ND-060004	SLIDER	1
03-77	HTL350-FNL.N-M8-DIN-2	HEXAGON THIN NUT	2
03-78	HTL350-HC.N-M8-DIN-2	CAP NUT	1
03-79	HTL350-032600	THROTTLE CABLE	1
03-80	HTL350-70ND-010018	THROTTLE LEVER ASSY	1

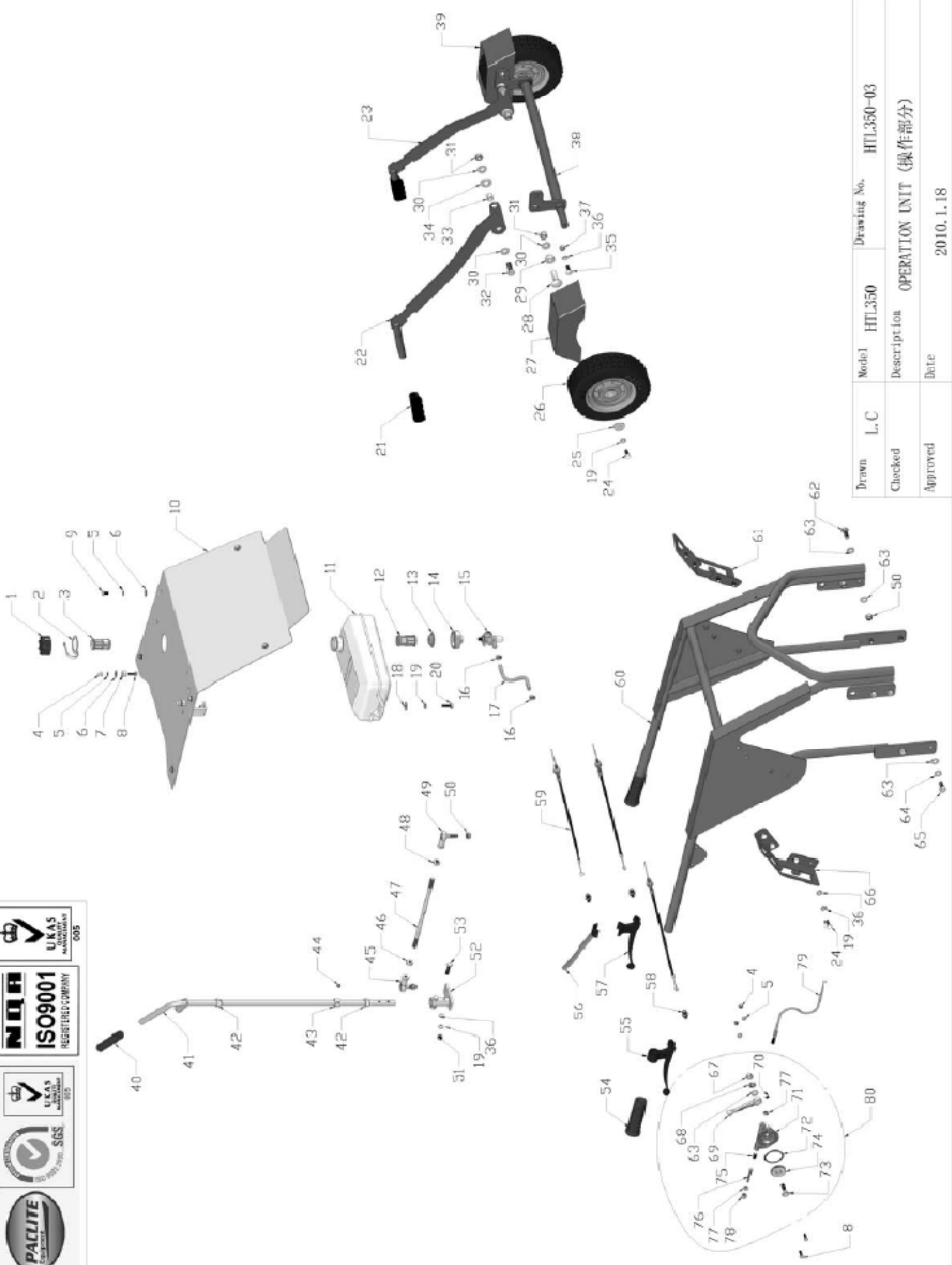
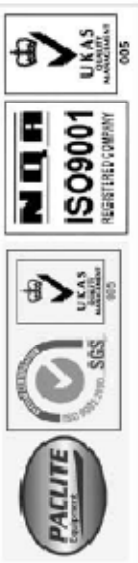

Drawn	L.C	Model	HTL350	Drawing No.	HTL350-03
Checked		Description	OPERATION UNIT (操作部分)		
Approved		Date	2010.1.18		

HTL350-04 FLATBED UNIT

NO. 序号	PART NO. 图号	PART DESCRIPTION 品名	QTY 数量
04-1	HTL350-040100	FLATBED BRACKET	1
04-2	HTL350-040000	FLATBED	2
04-3	HTL350-CHSN.B-M8x35-GB-2	BOLT	8
04-4	HTL350-FN.W8-DIN-2	WASHER	8
04-5	HTL350-IN.N-M8-DIN-2	LOCK NUT	8

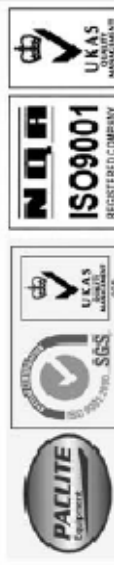

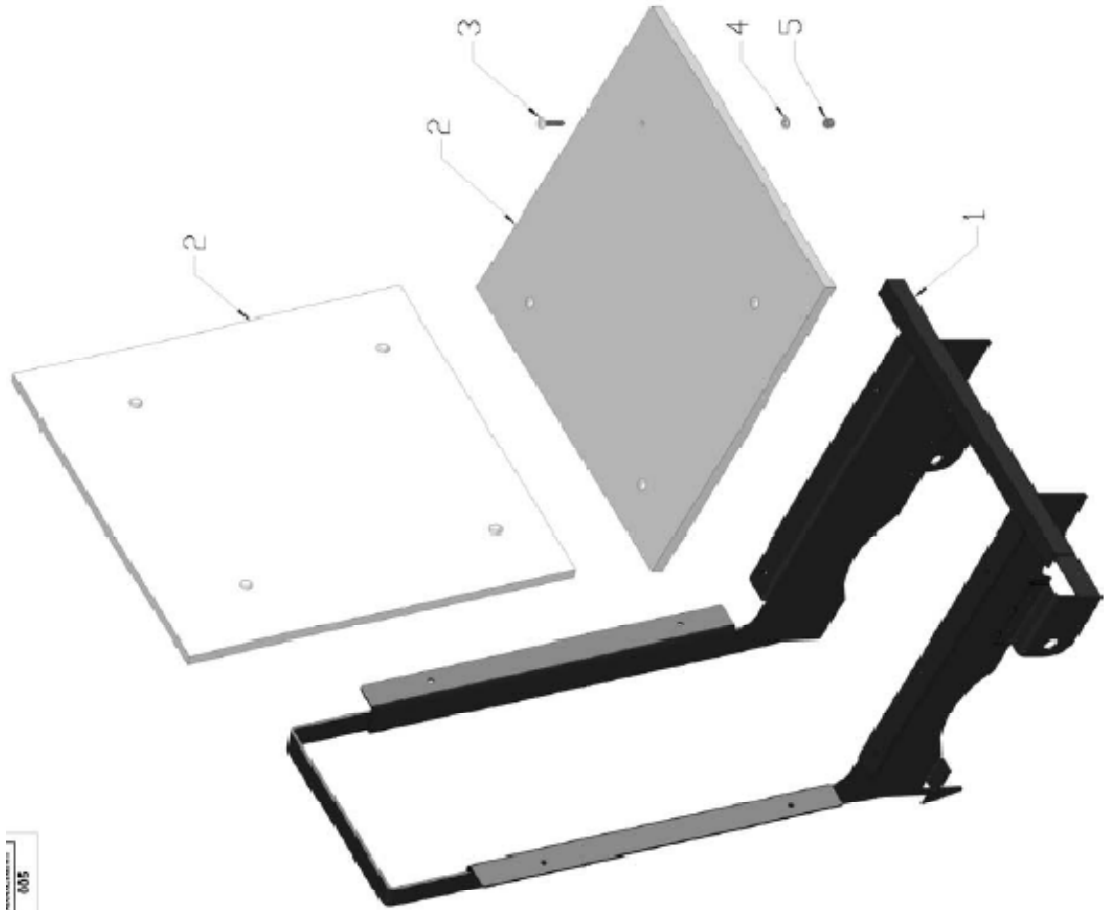

Drawn	L. C	Model	HTL350	Drawing No.	HTL350-04
Checked		Description	FLATBED UNIT(木板托架部分)		
Approved		Date	2010. 1. 18		

HTL350 TRANSAXLE

NO. 序号	PART NO. 图号	PART DESCRIPTION 品名	QTY 数量
1	772147	TRANSAXLE COVER	1
2	780086A	NEEDLE BEARING(1/2" LONG)	2
3	770128A	TRANSAXLE CASE	1
4B	776406	COUNTERSHAFT(B INPUT)	1
5	776409	OUTPUT SHAFT	1
6	778364	SPUR GEAR(38T-PM/SER)	1
6A	778369	SPUR GEAR(15T-PM/SER)	1
7	778330	SPUR GEAR(11T-PM/SER)	1
8	792180A	SHIFT KEY SET(QTY.2)	2
8A	792047	WOODRUFF KEY #9	1
9	784352	SHIFT COLLAR	1
10	784378	SHIFT ROD & FORK ASSY	1
11	778334	BEVEL GEAR(30T-PM)	1
12	778309	INPUT BEVEL PINION(13T-PM)	1
13	778368	BEVEL GEAR 13T(INCL. REF. 13&14)	1
14	778369	BEVEL GEAR 13T(INCL. REF. 13&14)	1
15	778370	RING GEAR(43T)	1
17	786188	DRIVE PIN	1
18	786102	SPACER(1.130x.695)	1
20	792077A	BALL(STAINLESS STEEL 5/16" DIA.)	1
21	792211	SCREW, 3/8-16 x 3/8"	1
22	792079	SPRING	1
25	792073A	SCREW 1/4-20 x 1-1/4"	1
25A	792177	SCREW 1/4-20 x 1-3/8"	17
26	792125	RETAINING RING	3
27	792035	RETAINING RING	4
28	788040	RETAINING RING	1
29	780072	WASHER .627ID. .031W	1
29A	780160	TRUST WASHER(.563 ID x .031W)	5
29B	780051	TURST WASHER(.762 ID x .031W)	1
30	780108	SHIFT WASHER(CUPPED)	2
31	780001	WASHER .750ID .56W	3
32	788083	OIL SEAL 5/8"	2
32A	792001	O RING(.832" OD)	1
34	780194	BUSHING(.563)	1
35	780193	FLANGED BUSHING(.625 ID)	2
35A	780197	FLANGED BUSHING(.751 ID)	2
36	790075	BRAKE DISK	2
37	790007	BRAKE PAD PLATE	1
38	799021A	BRAKE PAD(PKG OF 2)	1
39	786026	DOWEL PIN .3125 x .750	2
40	792076A	WASHER .312ID .059W	2
41	790013	BRAKE LEVER	1
42A	792085A	SCREW 1/4-20 x 2.25"	1
43	792075	LOCK NUT 5/16-24	1
44	790025	BRAKE PAD HOLDER	1

HTL350 TRANSAXLE

NO. 序号	PART NO. 图号	PART DESCRIPTION 品名	QTY 数量
45	786066	SPACER .2625W 1.0L	1
46	786086	BRACKET	1
47	774999	AXLE(11-1/16" LONG)(INCL .26)	1
48	774689	AXLE(15-5/8" LONG)(INCL .26)	1
49	778356	SPUR GEAR(29T-PM/IC)	1
50	778338	SPUR GEAR(27T-PM/IC)	1
51	778342	SPUR GEAR(22T-PM/IC)	1
52	778313	SPUR GEAR(19T-PM/IC)	1
56	778355	SPUR GEAR(11T-PM/SER)	1
57	778337	SPUR GEAR(13T-PM/SER)	1
58	778341	SPUR GEAR(18T-PM/SER)	1
59	778351	SPUR GEAR(21T-PM/SER)	1
63	786071	COUNTERSHAFT SPACER 1-1/8" x 3/8"	2
64	786072	BRAKE SPACER 1-1/8" x 3/8"	2
65	780189	WASHER .563ID .062W	1
66	776422	INPUT SHAFT	1
67	776396	BRAKE SHAFT	1
69	792170	RETAINING RING(.75 x .042)	1
70	786187	SPACER(.089)	1
71B	788092	O-RING	1
73	780140	NEEDLE BEARING .750 ID	2
75	786084	SLEEVE	2
76	780090	FLAT WASHER(1.128 ID x .058W)	1
77	788078A	RETAINING RING(1.125 x .050)	1
79	792144	SPRING	1
82	778363	BEVEL (30T) & SPUR GEAR(13T-PM/SER)	1
83	778338	SPUR GEAR(27T-PM/IC)	1
87	788089A	OIL SEAL 9/16" ID	1
157	788088A	OIL SEAL 3/4" ID	2

