

TR-670H-01 FUEL TANK & HANDLE ASSY

NO.	PART NO.	PART DESCRIPTION	QTY	Prix de vente Internet
01-1	TR-670H-70B-010112P	FUEL TANK CAP	1	30,15 €
01-2	TR-670H-70B-010113P	STRAP	1	4,08 €
01-3	TR-670H-70B-010110	STRAINER	1	18,60 €
01-4	TR-670H-85d-010109	FUEL TANK	1	70,02 €
01-5	TR-670H-FN.B-M10x30-8.8-DIN-1	BOLT	2	0,32 €
01-6	TR-670H-WOD.W10-GB-1	WASHER	2	0,20 €
01-7	TR-670H-70B-000020	FUEL VALVE	1	36,51 €
01-8	TR-670H-70B-000021	HOSE BAND	2	3,56 €
01-9	TR-670H-70B-000022	FUEL HOSE	1	7,04 €
01-10	TR-670H-85d-010100	OPERATION HANDLE	1	124,17 €
01-11	TR-670H-FN.W10-DIN-1	WASHER	2	0,16 €
01-12	TR-670H-IN.N-M10-DIN-1	LOCK NUT	2	0,24 €
01-13	TR-670H-FN.B-M10x25-8.8-DIN-1	BOLT	4	0,28 €
01-14	TR-670H-SPG.W10-DIN-1	SPRING WASHER	4	0,16 €
01-15	TR-670H-FN.B-M6x20-8.8-DIN-2	BOLT	2	0,16 €
01-16	TR-670H-SPG.W6-DIN-2	SPRING WASHER	2	0,16 €
01-17	TR-670H-HC.N-M6-DIN-2	CAP NUT	2	0,16 €
01-18	TR-670H-HC.N-M10-DIN-2	CAP NUT	1	0,40 €
01-19	TR-670H-FNL.N-M10-DIN-2	HEXAGON THIN NUT	1	0,20 €
01-20	TR-670H-FN.W10-DIN-2	WASHER	2	0,16 €
01-21	TR-670H-70ND-060000	THROTTLE LEVER	1	19,56 €
01-22	TR-670H-FHSS.S-M6x8-GB-3	SOCKET SCREW WITH FLAT HEAD	1	0,20 €
01-23	TR-670H-HC.N-M8-DIN-2	CAP NUT	1	0,24 €
01-24	TR-670H-FNL.N-M8-DIN-2	HEXAGON THIN NUT	2	0,16 €
01-25	TR-670H-FHSS.S-M8x20-GB-3	SOCKET SCREW WITH FLAT HEAD	1	0,24 €
01-26	TR-670H-70ND-060001	THROTTLE BODY	1	27,12 €
01-27	TR-670H-70ND-060003	BOLT	1	11,04 €
01-28	TR-670H-70ND-060002	THROTTLE GEAR	1	22,12 €
01-29	TR-670H-W04-45x3	O-RING	1	4,04 €
01-30	TR-670H-70ND-060004	SLIDER	1	6,52 €
01-31	TR-670H-W06-S04-L450x650	THROTTLE CABLE	1	26,16 €
01-32	TR-670H-65ND-010100	ROLLER	4	19,56 €
01-33	TR-670H-HF.B-M5x30-8.8-DIN-3	HEXAGON FLANGE BOLT	4	0,20 €
01-34	TR-670H-HF.N-M5-DIN-3	HEXAGON FLANGE NUT	4	0,16 €
01-35	TR-670H-70ND-010114	STRAINER	1	16,08 €
01-36	TR-670H-70ND-010115	PACKING	1	6,08 €
01-37	TR-670H-85d-010113	FUEL TANK CAP ,BOTTOM	1	28,60 €
01-38	TR-670H-70ND-000028	HANDLE FOAM	1	7,52 €
01-39	TR-670H-70ND-000029P	HANDLE FABRIC	1	13,04 €
01-40	TR-670H-70ND-010018	THROTTLE LEVER ASSY	1	67,77 €

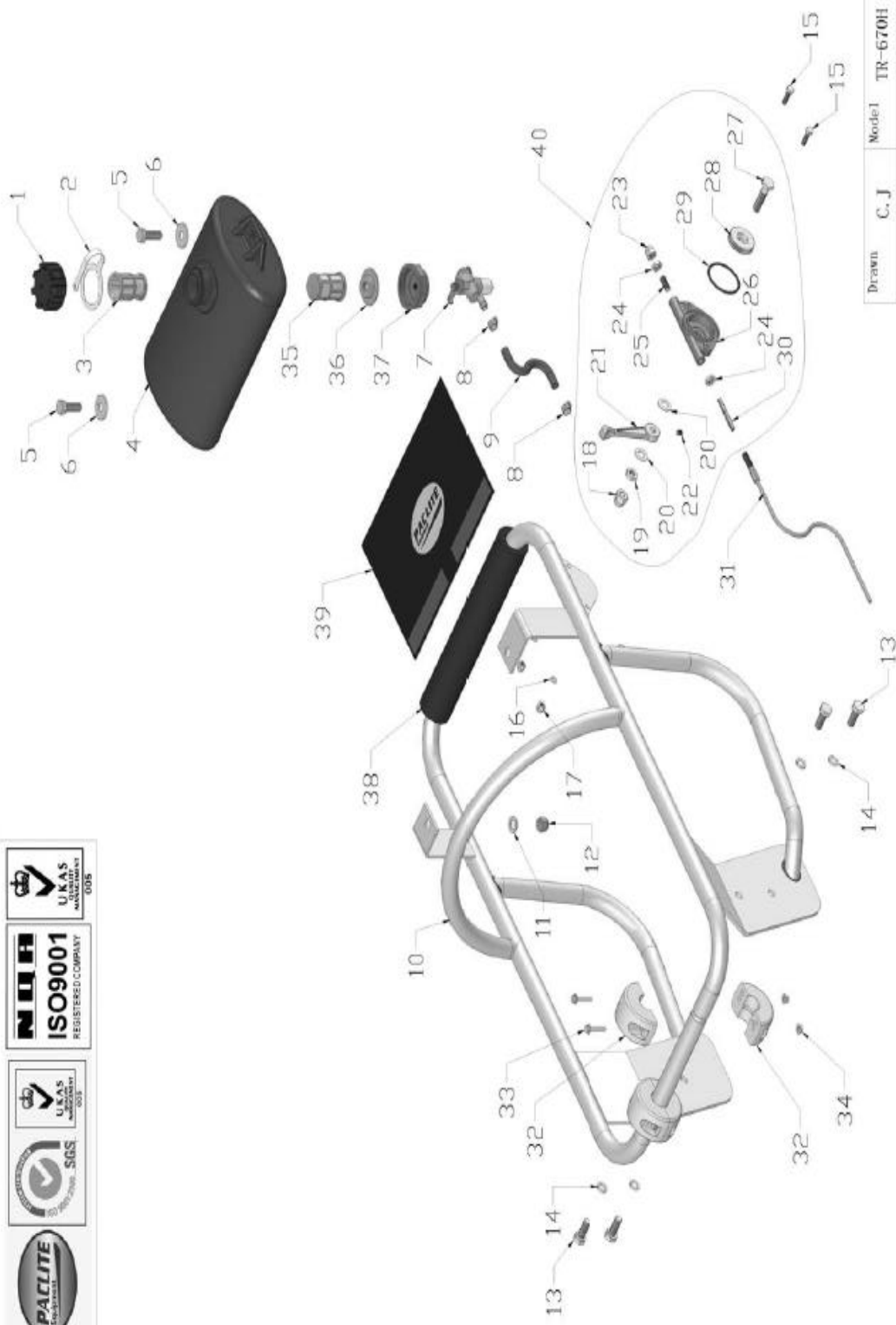

Drawn	C. J	Model	TR-670H	Drawing No.	TR-670H-01
Checked		Description	FUEL TANK & HANDLE ASSY		
Approved		Date			2009.11.10

TR-670H-02 GEAR CASE & ENGINE ASSY

NO.	PART NO.	PART DESCRIPTION	QTY	Prix de vente Internet
02-1	TR-670H-W05-GX120U1-KRS4	ENGINE	1	513,60 €
02-2	TR-670H-80-0997	WASHER	1	4,00 €
02-3	TR-670H-W18-C812A	CENTRIFUGAL CLUTCH ASSY	1	94,89 €
02-4	TR-670H-WKey-4x4x13	WOODRUFF KEY	1	22,60 €
02-5	TR-670H-FNL.N-M12x1.25-DIN-2	THIN NUT	1	0,28 €
02-6	TR-670H-FN.B-M8x25-8.8-DIN-1	BOLT	1	0,20 €
02-7	TR-670H-SPG.W8-DIN-1	SPRING WASHER	11	0,16 €
02-8	TR-670H-70B-020129	LOCK WASHER	1	3,04 €
02-9	TR-670H-70B-020119	CLUTCH HOUSING	1	79,80 €
02-10	TR-670H-65ND-020110	SPACER	1	31,47 €
02-11	TR-670H-W04-104.4x3.1	O RING	1	4,08 €
02-12	TR-670H-W03-52x40x8	OIL SEAL	1	4,08 €
02-13	TR-670H-W01-6207Z-J	BEARING	1	18,08 €
02-14	TR-670H-CS.RG35	EXTERNAL CIRCLIP	2	0,40 €
02-15	TR-670H-W01-6304-J	BEARING	1	15,12 €
02-16	TR-670H-Key.A-5x5x22	KEY	1	4,08 €
02-17	TR-670H-70B-020124	PINION	1	75,99 €
02-18	TR-670H-65ND-020100	GEAR CASE	1	147,04 €
02-19	TR-670H-70B-020106	BREATHER BOLT	1	10,08 €
02-20	TR-670H-K.RVT-2.5x5	RIVET	4	0,16 €
02-21	TR-670H-80-0409	NAMEPLATE	1	1,52 €
02-22	TR-670H-70B-020101	WASHER	1	8,84 €
02-23	TR-670H-W01-TAF324220	BEARING	1SET	37,65 €
	TR-670H-RT283220			0,00 €
02-24	TR-670H-70B-020112	INTERNAL CIRCLIP	1	2,56 €
02-25	TR-670H-W01-6207-J	BEARING	1	15,56 €
02-26	TR-670H-CH.RG72	INTERNAL CIRCLIP	1	1,80 €
02-27	TR-670H-65ND-020200	CRANK GEAR	1	191,16 €

02-28	TR-670H-70B-020102	CONNECTING ROD	1	82,41 €
02-29	TR-670H-W01-6204-J	BEARING	1	9,52 €
02-30	TR-670H-CS.RG20	EXTERNAL CIRCLIP	1	0,20 €
02-31	TR-670H-CH.RG47	INTERNAL CIRCLIP	1	0,56 €
02-32	TR-670H-70B-020114	PACKING FRONT COVER	1	7,04 €
02-33	TR-670H-65ND-020101P	FRONT COVER	1	41,40 €
02-34	TR-670H-FN.W8-DIN-1	WASHER	14	0,16 €
02-35	TR-670H-FN.B-M8x20-8.8-DIN-1	BOLT	6	0,20 €
02-36	TR-670H-FN.B-M10x1.25x45-8.8-DIN-1	BOLT	3	0,36 €
02-37	TR-670H-70B-020125	SHOCK ABSORBER	2	79,77 €
02-38	TR-670H-HS.B-M10x35-8.8-GB-1	SCREW	4	0,32 €
02-39	TR-670H-SPG.W10-DIN-1	SPRING WASHER	11	0,16 €
02-40	TR-670H-FN.W10-DIN-1	WASHER	7	0,16 €
02-41	TR-670H-65ND-020300	BRACKET	1	33,09 €
02-42	TR-670H-FN.N-M8-DIN-1	NUT	4	0,16 €
02-43	TR-670H-FN.B-M8x40-8.8-DIN-1	BOLT	4	0,24 €
02-44	TR-670H-FN.B-M10x25-8.8-DIN-1	BOLT	4	0,24 €
02-45	TR-670H-80-0998	LOCK WASHER	1	0,20 €

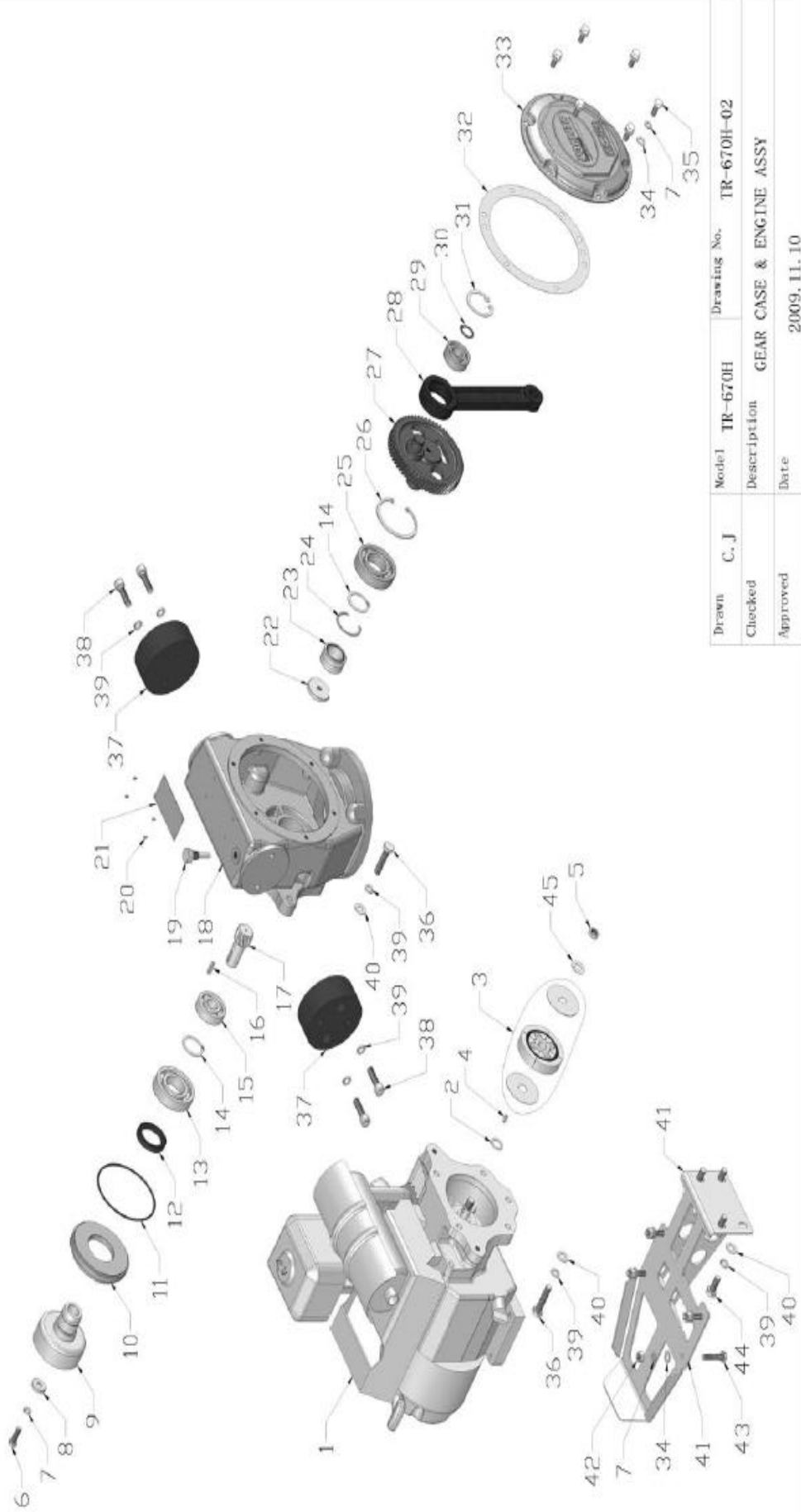

Drawn	C. J	Model	TR-670H	Drawing No.	TR-670H-02
Checked		Description	GEAR CASE & ENGINE ASSY		
Approved		Date			2009.11.10

TR-670H-03 GUIDE CYLINDER & SPRING ASSY

NO.	PART NO.	PART DESCRIPTION	QTY	Prix de vente Internet
03-1	TR-670H-65ND-020228	PISTON ROD	1	142,00 €
03-2	TR-670H-70B-020215	PISTON PIN	1	26,60 €
03-3	TR-670H-CS.RG16	EXTERNAL CIRCLIP	2	0,20 €
03-4	TR-670H-W04-124.4x3.1	O RING	1	4,08 €
03-5	TR-670H-HHOS.B-M20x1.5	HEXAGON HEAD PLUG	1	2,04 €
03-6	TR-670H-GB97.1-M20	CUPRUM WASHER	1	4,44 €
03-7	TR-670H-65ND-020400	GUIDE CYLINDER (TOP)	1	164,34 €
03-8	TR-670H-FN.W12-DIN-1	WASHER	4	0,16 €
03-9	TR-670H-SPG.W12-DIN-1	SPRING WASHER	4	0,16 €
03-10	TR-670H-HS.B-M12x45	SCREW	4	0,40 €
03-11	TR-670H-70B-021000	BELLOW HOOP	2	9,56 €
03-12	TR-670H-70B-020216	BELLOW	1	131,46 €
03-13	TR-670H-70B-020219	SPRING GUIDE (MIDDLE)	1	32,16 €
03-14	TR-670H-70B-020202	OUTTER SPRING	2	72,60 €
03-15	TR-670H-70B-020201	INNER SPRING	2	59,07 €
03-16	TR-670H-70B-020210	PISTON	1	39,68 €
03-17	TR-670H-70B-020211	PISTON RING	2	32,79 €
03-18	TR-670H-SPG.W22-DIN-1	SPRING WASHER	1	0,24 €
03-19	TR-670H-FN.N-M22x1.5-DIN-3	NUT	1	1,52 €
03-20	TR-670H-65ND-020500	GUIDE CYLINDER (BOTTOM)	1	187,44 €
03-21	TR-670H-100GB-041000	OIL GAUGE	1	21,08 €
03-22	TR-670H-HSHOS.B-G1/8	HEXAGONAL SOCKET HEAD PLUG	1	1,72 €
03-23	TR-670H-70B-020223	SPRING GUIDE (BOTTOM)	1	17,56 €
03-24	TR-670H-W04-90x3.5	O RING	1	4,00 €
03-25	TR-670H-65ND-020225	FLANGE	1	39,90 €
03-26	TR-670H-FN.W6-DIN-1	WASHER	8	0,16 €
03-27	TR-670H-SPG.W6-DIN-1	SPRING WASHER	8	0,16 €
03-28	TR-670H-FN.B-M6x25-8.8-DIN-1	BOLT	8	0,16 €
03-29	TR-670H-70B-030102	FOOT PLATE	1	48,18 €

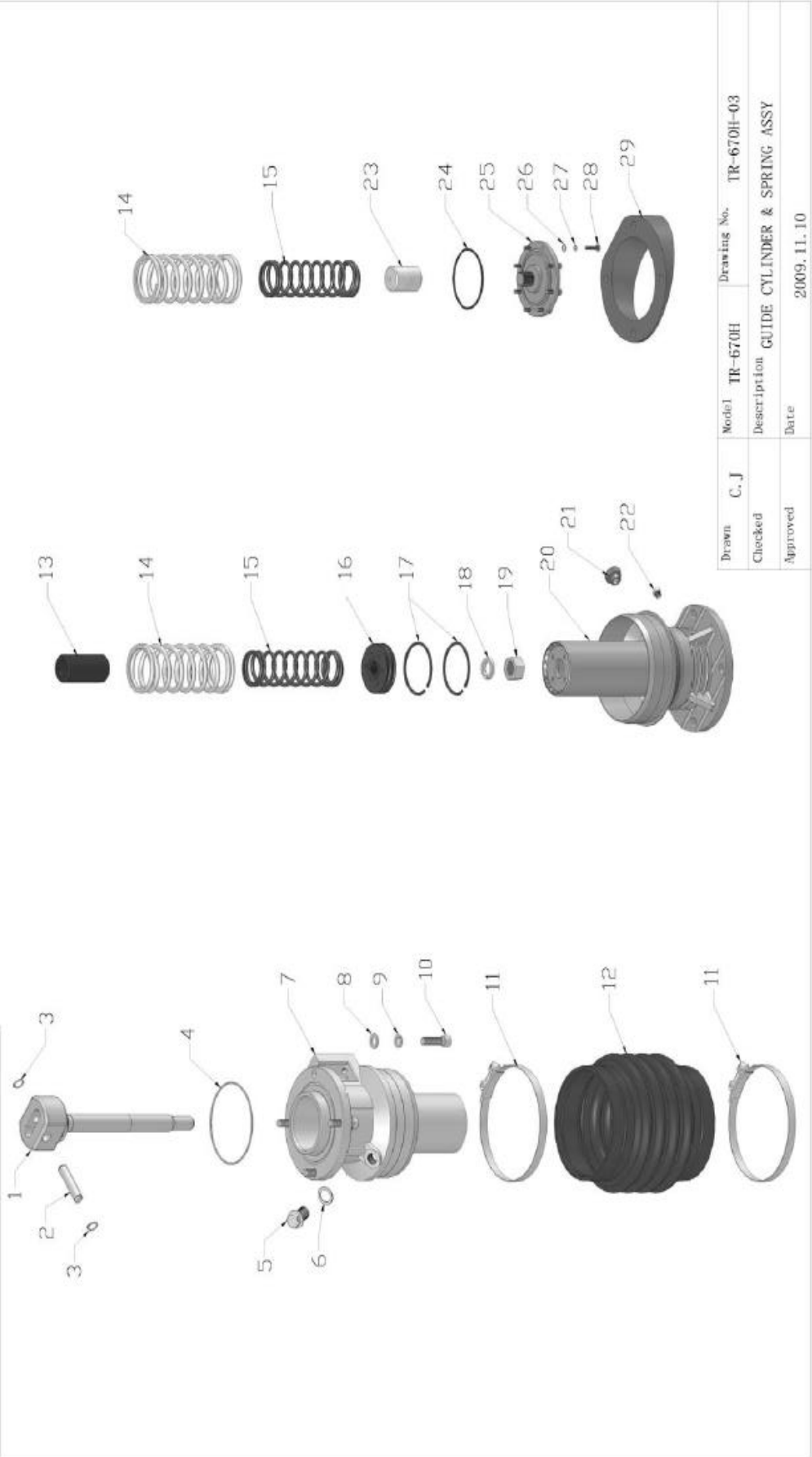

Drawn	C. J	Model	TR-670H	Drawing No.	TR-670H-03
Checked		Description GUIDE CYLINDER & SPRING ASSY			
Approved		Date	2009. 11. 10		

TR-670H-04 RAMMER SHOE ASSY				
NO.	PART NO.	PART DESCRIPTION	QTY	Prix de vente Internet
04-1	TR-670H-70B-030105	RAMMER SHOE STEEL PLATE	1	107,64 €
04-2	TR-670H-70B-030104	RAMMER SHOE WOODEN PLATE	1	91,44 €
04-3	TR-670H-70B-030101	RAMMER SHOE CLAMP PLATE	2	18,56 €
04-4	TR-670H-FSN.B-M12x95	SUNK HEAD BOLT	2	8,52 €
04-5	TR-670H-FSN.B-M12x130	SUNK HEAD BOLT	2	11,04 €
04-6	TR-670H-70B-030103	WASHER	4	8,00 €
04-7	TR-670H-FN.W12-DIN-1	WASHER	4	0,16 €
04-8	TR-670H-SPG.W12-DIN-1	SPRING WASHER	4	0,16 €
04-9	TR-670H-IN.N-M12-DIN-1	LOCK NUT	4	0,32 €
04-10	TR-670H-FSN.B-M10x55	SUNK HEAD BOLT	3	5,52 €
04-11	TR-670H-FN.W10-DIN-1	WASHER	6	0,16 €
04-12	TR-670H-IN.N-M10-DIN-1	LOCK NUT	7	0,24 €
04-13	TR-670H-WOD.W10-DIN-1	LARGE WASHER	2	0,16 €
04-14	TR-670H-EYE.N-M10	EYE NUT	1	8,00 €
04-15	TR-670H-SPG.W10-DIN-1	SPRING WASHER	1	0,16 €
04-16	TR-670H-FSN.B-M10x55	SUNK HEAD BOLT	5	6,04 €
04-17	TR-670H-65ND-030100	HANDLE	1	17,08 €

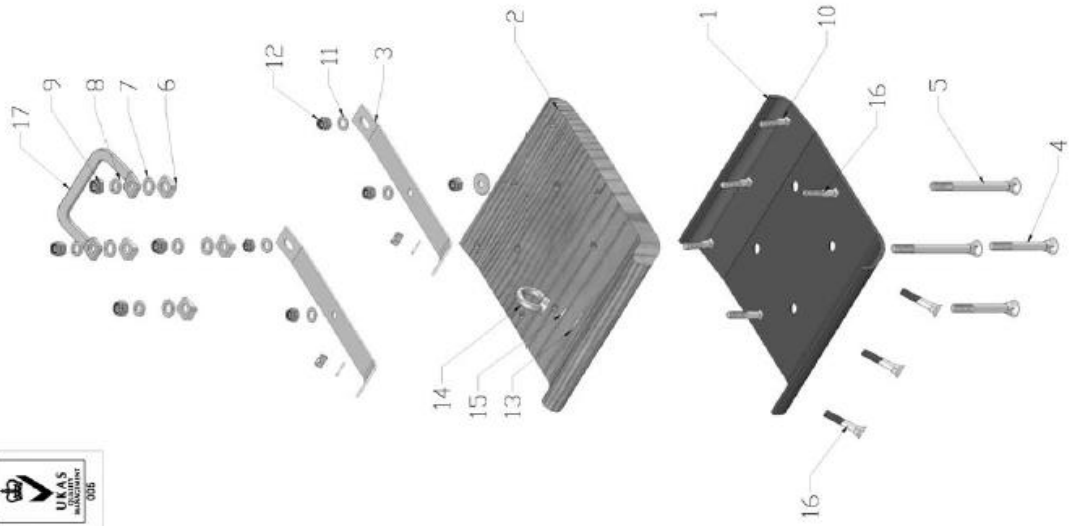
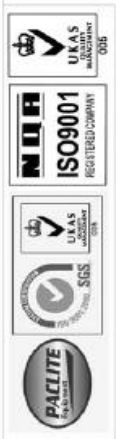

Drawn	C. J	Model	TR-670H	Drawing No.	TR-670H-04
Checked		Description	RAMMER SHOE ASSY		
Approved		Date	2009. 11. 10		