

PC60-01 MAIN FRAME ASSY.

| NO. | PART NO. | PART DESCRIPTION | QTY | UNIT PRICE 2019 (EUR) |
|-------|----------------------------|-------------------------|-----|--------------------------|
| 01-1 | PC60-IN.N-M12-DIN-1 | LOCK NUT | 6 | € 0,50 |
| 01-2 | PC60-FN.W12-DIN-1 | WASHER | 16 | € 1,30 |
| 01-3 | PC60-60III-060100 | CUSHION | 4 | € 30,90 |
| 01-4 | PC60-60W-010100S | BASE PLATE | 1 | € 373,26 |
| 01-5 | PC60-90P-010100 | HANDLE | 2 | € 43,60 |
| 01-6 | PC60-FN.B-M12x25-8.8-DIN-1 | BOLT | 4 | € 0,45 |
| 01-7 | PC60-HSPG.W12-DIN-1 | SPRING WASHER,TANG ENDS | 10 | € 0,30 |
| 01-8 | PC60-90P-010600 | RUBBER WASHER | 8 | € 4,55 |
| 01-9 | PC60-HS.B-M12x45-12.9-GB-3 | SCREW | 6 | € 1,60 |
| 01-10 | PC60-WOD.W8-GB-1 | WASHER | 14 | € 0,30 |
| 01-11 | PC60-60-060200 | BOLT | 1 | € 10,55 |
| 01-12 | PC60-90P-031000 | FIX ENGINE BOLT | 1 | € 18,65 |
| 01-13 | PC60-60W-020100 | ENGINE BASE | 1 | € 110,43 |
| 01-14 | PC60-FN.N-M10-DIN-1 | NUT | 1 | € 0,35 |
| 01-15 | PC60-FN.B-M10x45-8.8-DIN-1 | BOLT | 1 | € 0,45 |
| 01-16 | PC60-HSPG.W8-DIN-1 | SPRING WASHER,TANG ENDS | 24 | € 0,30 |
| 01-17 | PC60-FN.B-M8x20-8.8-DIN-1 | BOLT | 6 | € 0,35 |
| 01-18 | PC60-80-0409 | NAMEPLATE | 1 | € 2,30 |
| 01-19 | PC60-K.RVT-3.2x11 | RIVET | 4 | € 0,45 |
| 01-20 | PC60-80-0408 | CUSHION | 2 | € 15,15 |
| 01-21 | PC60-IN.N-M10-DIN-1 | LOCK NUT | 4 | € 0,40 |
| 01-22 | PC60-FN.N-M8-DIN-1 | NUT | 2 | € 0,30 |
| 01-23 | PC60-FN.B-M8x45-8.8-DIN-1 | BOLT | 2 | € 0,30 |
| 01-24 | PC60-500S-010505 | BUCKLE | 1 | € 40,50 |
| 01-25 | PC60-SPG.W5-DIN-1 | SPRING WASHER | 4 | € 0,30 |
| 01-26 | PC60-FN.B-M5x10-8.8-DIN-1 | BOLT | 4 | € 0,35 |
| 01-27 | PC60-60W-060200 | OUTER BELT GUARD | 1 | € 87,25 |
| 01-28 | PC60-60W-060300 | SEAL | 1 | € 24,80 |
| 01-29 | PC60-FN.B-M8x25-8.8-DIN-1 | BOLT | 5 | € 0,35 |
| 01-30 | PC60-80-0319 | WASHER | 1 | € 6,00 |
| 01-31 | PC60-CH.RG55 | INTERNAL CIRCLIP | 1 | € 0,90 |
| 01-32 | PC60-W02-A30 | V-BELT | 1 | € 29,80 |
| 01-33 | PC60-40-0318 | CLUTCH PULLEY | 1 | € 142,00 |
| 01-34 | PC60-CS.RG30 | EXTERNAL CIRCLIP | 1 | € 0,40 |
| 01-35 | PC60-W01-6006ZZ-J | BEARING | 1 | € 17,35 |
| 01-36 | PC60-80-0500C | CENTRIFUGAL CLUTCH | 1 | € 177,30 |
| 01-37 | PC60-Key.C-5x5x32 | KEY | 1 | € 9,00 |
| 01-38 | PC60-60W-060100 | INNER BELT GUARD | 1 | € 88,10 |
| 01-39 | PC60-IN.N-M8-DIN-1 | LOCK NUT | 4 | € 0,35 |
| 01-40 | PC60-W05-GX120 | ENGINE | 1 | € 0,00 |
| 01-41 | PC60-90P-010901 | HOOP | 3 | € 41,35 |
| 01-42 | PC60-FN.W8-DIN-1 | WASHER | 15 | € 0,30 |

PC60-01 MAIN FRAME ASSY.

| NO. | PART NO. | PART DESCRIPTION | QTY | UNIT PRICE 2019 (EUR) |
|-------|----------------------------|-----------------------------|-----|--------------------------|
| 01-43 | PC60-FN.B-M8x35-8.8-DIN-1 | BOLT | 5 | € 0,35 |
| 01-44 | PC60-60W-010800 | SPRINKLING PIPE | 1 | € 93,25 |
| 01-45 | PC60-HSHOS.B-ZG1-4 | HEXAGONAL SOCKET HEAD PLUG | 2 | € 1,90 |
| 01-46 | PC60-CPT-BT-1/4-10 | HOSE NIPPLE | 2 | € 11,50 |
| 01-47 | PC60-90P-070006 | HOSE CLAMP | 2 | € 2,30 |
| 01-48 | PC60-60W-010700 | HOSE | 1 | € 6,00 |
| 01-49 | PC60-QF-1/4-NI | VALVE | 1 | € 25,60 |
| 01-50 | PC60-CPT-BT-1/4 | JOINT | 1 | € 8,25 |
| 01-51 | PC60-CPT-JT-ZG1/4 | 90° ELBOW | 1 | € 11,25 |
| 01-52 | PC60-90P-070000 | WATER TANK | 1 | € 138,25 |
| 01-53 | PC60-6.5-070109 | SEAL,WATER TANK COVER | 1 | € 6,35 |
| 01-54 | PC60-6.5-070108 | WATER TANK CAP | 1 | € 30,10 |
| 01-55 | PC60-90P-050300 | WATER TANK CLIP | 1 | € 36,80 |
| 01-56 | PC60-60W-050100 | WATER TANK FRAME | 1 | € 163,05 |
| 01-57 | PC60-60W-040100 | WHEEL FRAME | 1 | € 112,70 |
| 01-58 | PC60-60W-040200 | WHEELE | 2 | € 71,45 |
| 01-59 | PC60-FN.B-M10x25-8.8-DIN-1 | BOLT | 2 | € 0,45 |
| 01-60 | PC60-FN.W10-DIN-1 | WASHER | 4 | € 0,30 |
| 01-61 | PC60-90B-030100 | HANDRAIL ABSORBER | 2 | € 21,10 |
| 01-62 | PC60-60W-030100-C | HANDRAIL | 1 | € 155,12 |
| 01-63 | PC60-FN.B-M6x20-8.8-DIN-2 | BOLT | 2 | € 0,30 |
| 01-64 | PC60-HSPG.W6-DIN-2 | SPRING WASHER,TANG ENDS | 2 | € 0,35 |
| 01-65 | PC60-HC.N-M6-DIN-2 | CAP NUT | 2 | € 0,30 |
| 01-66 | PC60-HC.N-M10-DIN-2 | CAP NUT | 1 | € 0,60 |
| 01-67 | PC60-FNL.N-M10-DIN-2 | HEXAGON THIN NUT | 1 | € 0,40 |
| 01-68 | PC60-70ND-060000 | THROTTLE LEVER | 1 | € 29,05 |
| 01-69 | PC60-FHSS.S-M6x8-GB-3 | SOCKET SCREW WITH FLAT HEAD | 1 | € 0,35 |
| 01-70 | PC60-70ND-060001 | THROTTLE BODY | 1 | € 40,55 |
| 01-71 | PC60-W04-45x3 | O-RING | 1 | € 6,00 |
| 01-72 | PC60-70ND-060003 | BOLT | 1 | € 16,55 |
| 01-73 | PC60-70ND-060002 | THROTTLE GEAR | 1 | € 33,05 |
| 01-74 | PC60-FHSS.S-M8x20-GB-3 | SOCKET SCREW WITH FLAT HEAD | 1 | € 3,30 |
| 01-75 | PC60-70ND-060004 | SLIDER | 1 | € 9,75 |
| 01-76 | PC60-FNL.N-M8-DIN-2 | HEXAGON THIN NUT | 2 | € 0,30 |
| 01-77 | PC60-HC.N-M8-DIN-2 | CAP NUT | 1 | € 0,45 |
| 01-78 | PC60-FN.W10-DIN-2 | WASHER | 2 | € 0,30 |
| 01-79 | PC60-W06-S04-L800x1000 | THROTTLE CABLE | 1 | € 61,80 |
| 01-80 | PC60-70ND-010018 | THROTTLE LEVER ASSY | 1 | € 90,93 |
| 01-81 | PC60-02 | EXCITER HOUSING ASSY | 1 | € 0,00 |
| 01-82 | PC60-010300.3 | NYLON BUSH | 2 | € 16,60 |

PC60-01 MAIN FRAME ASSY.

| NO. | PART NO. | PART DESCRIPTION | QTY | UNIT PRICE 2019 (EUR) |
|-----|----------|------------------|-----|--------------------------|
|-----|----------|------------------|-----|--------------------------|

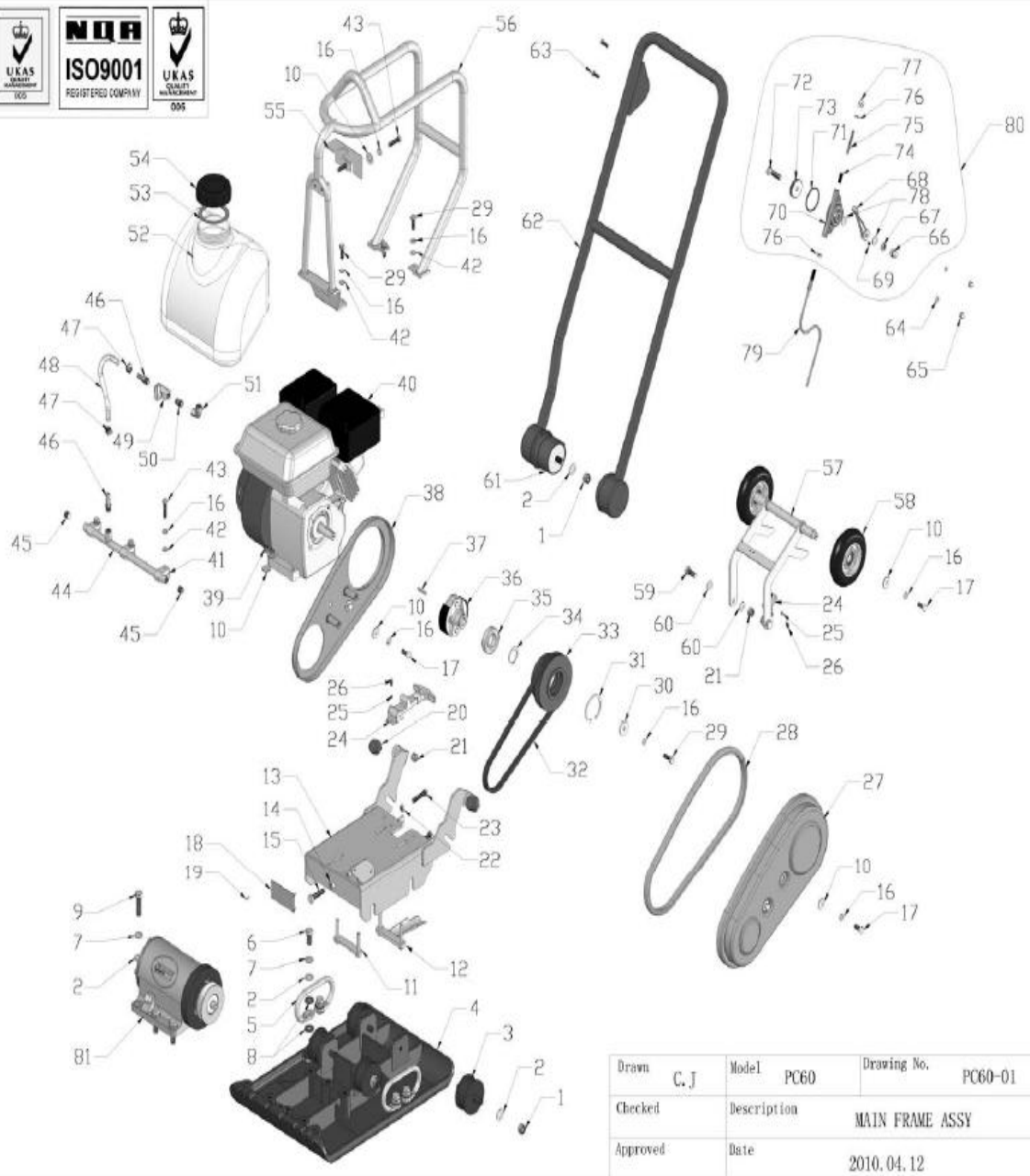

| | | | | | |
|----------|------|-------------|-----------------|-------------|---------|
| Drawn | C. J | Model | PC60 | Drawing No. | PC60-01 |
| Checked | | Description | MAIN FRAME ASSY | | |
| Approved | | Date | 2010. 04. 12 | | |

PC60-01 MAIN FRAME ASSY.





| NO. | PART NO. | PART DESCRIPTION | QTY | UNIT PRICE 2019 (EUR) |
|-----|----------|------------------|-----|--------------------------|
|-----|----------|------------------|-----|--------------------------|

PC60-02 EXCITER HOUSING ASSY.

| NO. | PART NO. | PART DESCRIPTION | QTY | UNIT PRICE 2019 (EUR) |
|-------|---------------------------|-------------------------|-----|--------------------------|
| 02-1 | PC60-FN.B-M8x30-8.8-DIN-1 | BOLT | 8 | € 0,40 |
| 02-2 | PC60-HSPG.W8-DIN-1 | SPRING WASHER,TANG ENDS | 8 | € 0,30 |
| 02-3 | PC60-FN.W8-DIN-1 | WASHER | 8 | € 0,30 |
| 02-4 | PC60-60-010400 | CLOSE COVER | 1 | € 39,05 |
| 02-5 | PC60-W04-80x3.5 | O RING | 2 | € 6,00 |
| 02-6 | PC60-CS.RG35 | EXTERNAL CIRCLIP | 2 | € 0,55 |
| 02-7 | PC60-W01-6307Z-J | BEARING | 2 | € 49,25 |
| 02-8 | PC60-60W-010200 | EXCITER SHAFT | 1 | € 138,30 |
| 02-9 | PC60-60-010200P | EXCITER HOUSING | 1 | € 304,71 |
| 02-10 | PC60-GB97.1-M14 | CUPRUM WASHER | 1 | € 0,55 |
| 02-11 | PC60-HHOS.B-M14x1.5 | HEXAGON HEAD PLUG | 1 | € 2,30 |
| 02-12 | PC60-60-010700 | BUSH | 1 | € 3,75 |
| 02-13 | PC60-60-010300 | COVER | 1 | € 39,10 |
| 02-14 | PC60-W03-65x35x12 | OIL SEAL | 1 | € 9,00 |
| 02-15 | PC60-60III-010500 | COVER GUARD | 1 | € 26,95 |
| 02-16 | PC60-40-060200 | EXCITER PULLEY | 1 | € 71,40 |
| 02-17 | PC60-60-060301 | WASHER | 1 | € 22,55 |
| 02-18 | PC60-HSPG.W10-DIN-1 | SPRING WASHER,TANG ENDS | 1 | € 0,30 |
| 02-19 | PC60-90B-010800 | VENT SCREW | 1 | € 3,00 |

PC60-01 MAIN FRAME ASSY.

| NO. | PART NO. | PART DESCRIPTION | QTY | UNIT PRICE 2019 (EUR) |
|-----|----------|------------------|-----|--------------------------|
|-----|----------|------------------|-----|--------------------------|

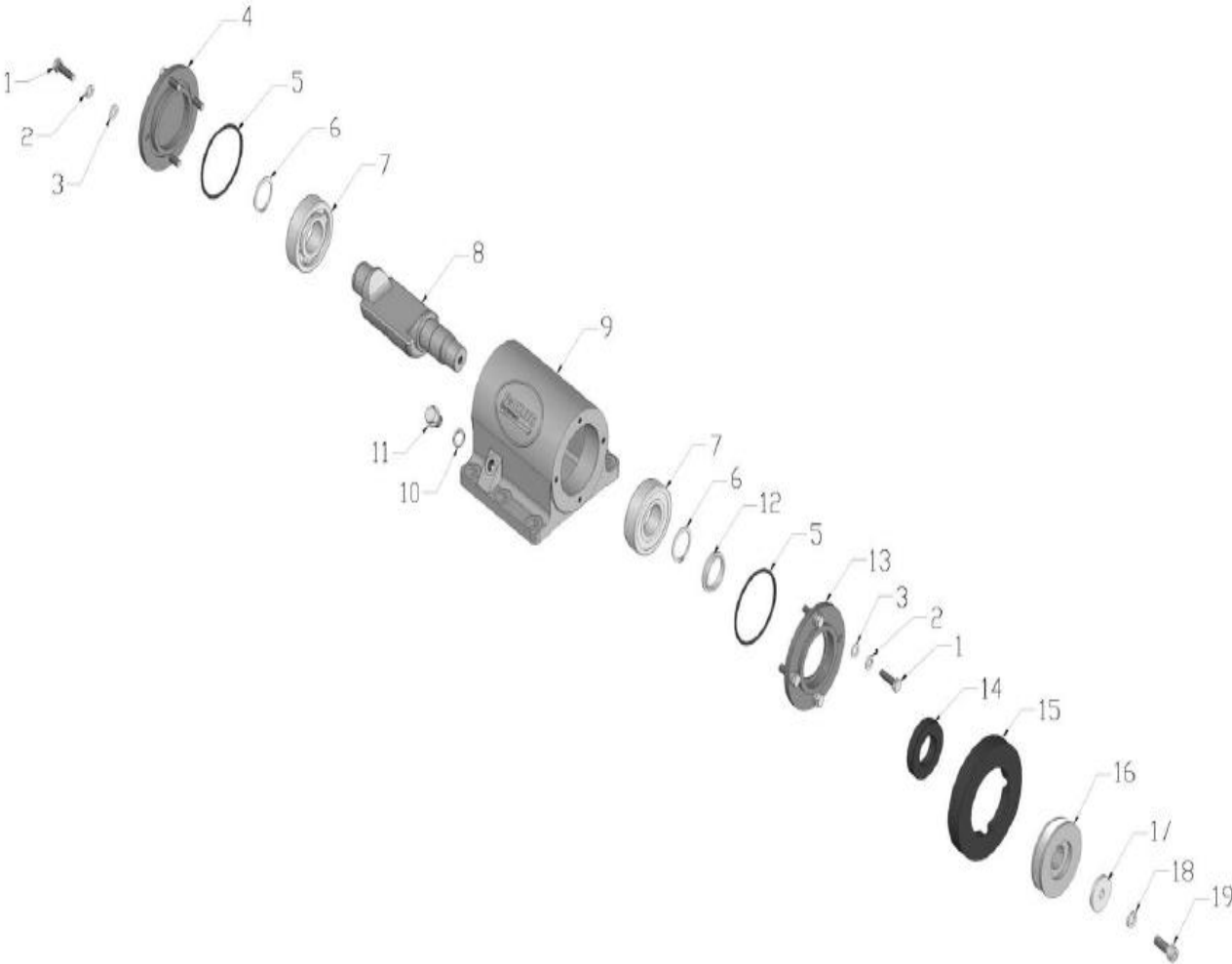

| | | | | | |
|----------|-------------------------------------|-------|------|-------------|---------|
| Drawn | C. J | Model | PC60 | Drawing No. | PC60-02 |
| Checked | Description EXCITER HOUSING ASSY | | | | |
| Approved | Date 2010.04.12 | | | | |